

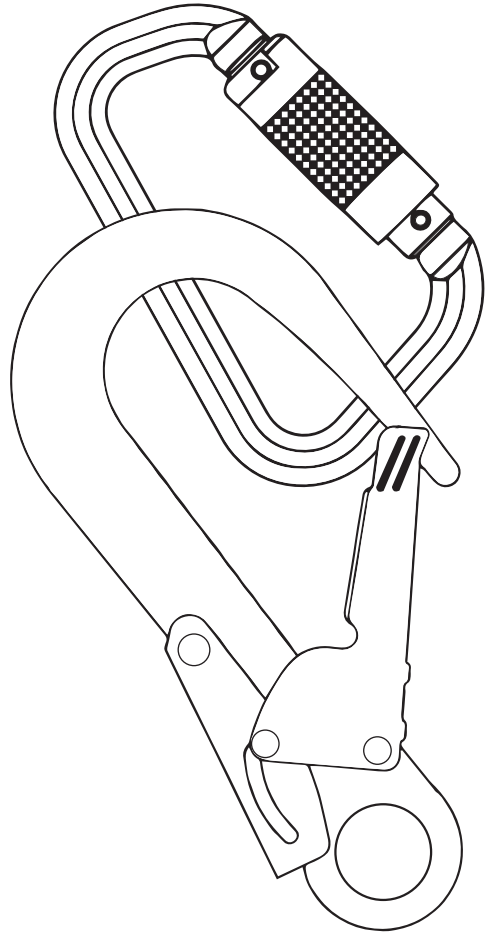

# CONNECTORS

## INSTRUCTIONS ON USE, CARE AND INSPECTION



### CAREFULLY READ THESE INSTRUCTIONS BEFORE USING THIS PRODUCT.

This Connector is designed to minimize the risk of/provide protection against the danger of falling from heights. However, always remember that no item of PPE can provide full protection and care must always be taken while carrying out the risk related activity.

### THIS INSTRUCTION FOR USE BOOKLET COVERS THE FOLLOWING JSP PRODUCTS:

- Screw gate connectors (FAR0902, FAR0904)
- Twist lock connectors (FAR0903, FAR0905)
- Triple lock connectors (FAR0941)
- Aluminium Rebar Hooks (FAR0908, FAR0901)

### THE USER IS ADVISED TO KEEP THE USER INSTRUCTIONS DOCUMENT FOR THE LIFE OF PRODUCT.

A copy of this manual and the Declaration of Conformity for the product can be found at [documents.jspsafety.com](http://documents.jspsafety.com).



[www.jspsafety.com](http://www.jspsafety.com)

<b>EN</b>	Instructions on use, care and inspection	<b>3</b>
<b>FR</b>	Instructions pour l'utilisation, l'entretien et l'inspection	<b>8</b>
<b>DE</b>	Anleitung zu gebrauch, pflege und überprüfung	<b>14</b>
<b>NO</b>	Bruks-, pleie og inspeksjonsanvisninger	<b>20</b>
<b>SV</b>	Instruktioner för användning, skötsel och inspektion	<b>26</b>
<b>FI</b>	Käyttö-, hoito- ja tarkastusohjeet	<b>32</b>
<b>ES</b>	Instrucciones de uso, cuidado e inspección	<b>38</b>
<b>PT</b>	Instruções de utilização, conservação e inspeção	<b>44</b>
<b>IT</b>	Istruzioni per l'uso, la cura e l'ispezione	<b>50</b>
<b>PL</b>	Instrukcje dotyczące użytkowania, konserwacji i kontroli	<b>56</b>
<b>CS</b>	Návod k použití, péči a prohlídce	<b>63</b>
<b>SK</b>	Návod na používanie, údržbu a kontrolu	<b>68</b>

# MARKING

Marking on the connectors, which must be in place, intact and legible while the connector is in use.



1. Manufacturer
2. Conformity mark to the Regulation (EU) 2016/425
3. Controlling Notified body
4. Minimum breaking load
5. Standard number/year
6. Class of the standard to which the product complies
7. Read the User Instructions

# DESCRIPTION

This connector is classed as a Personal Protective Equipment (PPE) by the European PPE Regulation (EU) 2016/425 and has been shown to comply with this regulation through the Harmonized European Standard EN 362:2004 Class:

**Q:** Connector which is closed by a screw-motion gate, which is a load bearing part of the connector when fully screwed up, intended to be used only for long-term or permanent connections.

**B:** Basic connector, self-closing connector intended to be used as a component.

**M:** Basic or screw link connector intended to be used as a component, which may be loaded in the major and minor axis.

**T:** Termination connector self-closing connector designed to allow the fixing as an element of a sub-system in such a way that the loading is in a predetermined direction.

**A:** Anchor connector, connector which closes automatically, designed to be linked directly to a specific type of anchor as a component.

**Certification body:** SATRA Technology Europe Ltd, Bracetown Business Park, Clonee, Dublin D15 YN2P Ireland (Notified Body 2777)

**Ongoing Assessment Body:** SGS United Kingdom Ltd., Unit 202B, Worle Parkway, Weston-super-Mare, BS22 6WA, UNITED KINGDOM. (Notified Body 0120)

# APPLICATION AND LIMITATIONS

## APPLICATION

The connector has been tested in accordance with EN 362 and found to achieve the specified performance levels as laid down in the norm:

- This connector is used for connecting two or more components of a fall restraint work positioning or fall arrest system. Generally all components have attachment elements, or loops or eyes etc. which can facilitate easy connection to the other component by use of a connector. The connector can also be used as a fixed termination in a lanyard or energy absorber.
- For connectors with self-closing and manual locking gates, it is recommended that they should only be used where the user does not have to attach and remove the connector frequently.
- A connector should never be loaded across its gate.
- Screw gate (Class Q) connectors should only be used where connections are infrequent.
- Screw gate connectors are only safe for use when the screw gate is fully closed. Ensure the screw gate is sufficiently hand tightened.
- The length of connector should be taken into account when used in a fall arrest system.
- Avoid situations that may reduce the strength of connector e.g. connecting to wide straps.

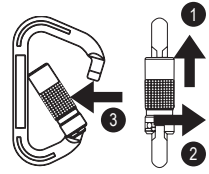
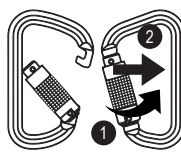
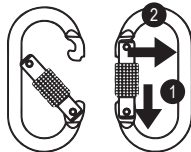
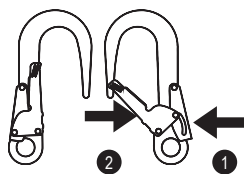
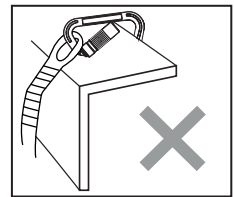
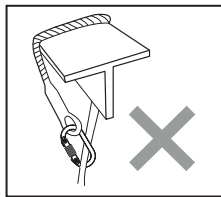
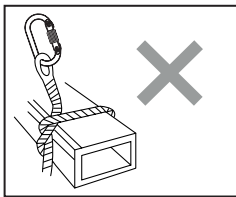
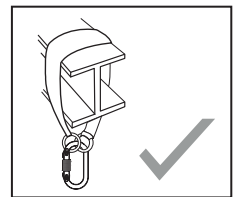
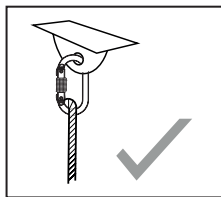
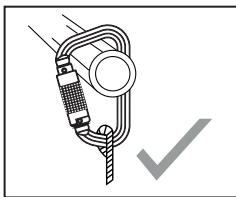

The chart below highlights connector materials and their respective gate opening dimensions:

JSP ID	FAR0902	FAR0903	FAR0905	FAR0901	FAR0908	FAR0941
Material	Alloy steel	Alloy steel	Aluminium	Aluminium	Aluminium	Aluminium
Gate Opening in mm	18	22.5	21	60	60	20
EN 362 type	B and M	B	B	T	T	B

## LIMITATIONS

- Do not use if you have any medical conditions which could affect your safety in both normal and emergency use;
- The equipment shall only be used by a person trained and competent in its safe use.
- A rescue plan shall be in place to deal with any emergencies that could arise during work.
- Do not make any alterations or additions to the equipment without the manufacturer's prior written consent.
- The equipment should not be used outside its limitation, or for any purpose other than that for which it is intended.
- The product should be the personal property of its user.
- Ensure the compatibility of items of equipment when assembled into a system.
- It is important to check before use for any dangers that may arise by the use of combinations of equipment in which the safe function of any one item is affected by or interferes with the safe function of another.
- Carry out a pre-use check of the product, to ensure that it is in a serviceable condition & operates correctly before it is used.
- Withdraw from use any equipment where there is any doubt about its condition for safe use or if it has been used to arrest a fall. Do not use again until it is confirmed by a competent person.
- Ensure that the strength of anchor device selected is equal to or greater than 12 kN.
- When intended to be used in a fall arrest systems, it is essential for safety that the anchor device or anchor point should always be positioned and the work carried out in such a way as to minimise both the pendulum and the potential fall distance. When the fall arrest system must be placed above the position of the user, the manufacturer shall make a statement to that effect.
- When intended to be used in fall arrest systems, it is essential for safety to verify the free space required beneath the user at the workplace before each use, so that in case of a fall there will be no collision with the ground or other obstacle in the fall path.
- Be aware of hazards that may affect the performance or cause failure of the equipment, such as:
  - Extreme temperatures (below -15°C and above +50°C)
  - Aggressive environmental conditions including sand & grit, cement, hot surfaces, naked flames, welding splatter, sparks, electrical conductivity
  - Contact with: sharp edges, abrasive surfaces, chemicals
- Immediately stop using the product if it is exposed to any of the above or is damaged in any way until it has been inspected by a competent person.

## LIFETIME

The usable life is affected by the condition of the product.

## STORAGE AND TRANSPORT

The Personal Protective Equipment must be transported in a package that protects against moisture, mechanical, chemical and thermal attack. Store in a cool dry place. Avoid humid & acidic environment for storage.

## MAINTENANCE

In case of minor soiling, wipe the connector with a dry cotton cloth or a soft brush. Do not use any abrasive material. If the product is damaged it will NOT provide the optimum level of protection, and therefore, it should be immediately replaced. Never use a damaged product. Repairing is not possible, the product must be replaced.

# INSPECTION

## PRE-USE CHECK

Users of JSP Connectors must carry out a pre use check before each and every use:

- Checking the connectors for: rust and pitting, cracks, distortion / deformity, excessive wear, functioning freely and correctly, correct alignment of the gate.
- The safety of the connector depends on the pre use checks and periodic inspections and upon the continued efficiency & durability of the connector.

If any defect or damage is identified, the connector should not be used. It should be taken to a competent person responsible for the detailed recorded inspections for a thorough visual and tactile examination.

## DETAILED RECORDED INSPECTION

Detailed recorded inspections should:

- Be carried out by a trained competent person to ensure the safety and integrity of the product
- Recorded in the record table contained within these User Instructions
- Be carried out on a regular basis. The frequency of the detailed recorded inspection should:
  - Be deemed through risk assessment taking into account legislation, equipment type, frequency of use, and environmental conditions, which may accelerate the rate of deterioration and physical damage
  - Be carried out at least every 12 months regardless of usage
- If any damage or failure are observed, the product should be removed from service and replaced immediately

## INSPECTION CARD

This user manual and operating instructions are part of the safety system and all users should be totally familiar with its contents. It should be kept in a safe place and be freely available to users at all times. When this product is removed from its packaging the table on the opposite page should be completed taking the information from the product label. The table below should be used to record all Detailed Recorded Inspections at a frequency deemed through risk assessment but at least every 12 months.

# INSPECTION FORM

Product	Reference	Batch / Serial number	Purchasing date	Date of first use	Expiry/Date

Manufacturer	Address	Phone	Email

Date of inspection	Stitching	Textile (rope, webbing, steel, wire etc.)	Metallic part(s) Connectors, D-ring, buckles, grabs etc.	Fall indicator(s)	Shock pack	Manufacturing date	PASS/FAIL	Date of next inspection	Name of inspector	Signature